



Installation instructions

Akrapovič Exhaust Systems:
Slip-On and **Evolution**
for the
RENAULT CLIO III. RS 200



Installation instructions

Akrapovič Exhaust Systems:
Slip-On and **Evolution**
for the
RENAULT CLIO III. RS 200

Congratulations on purchasing an Akrapovič exhaust system. Please read the entire installation manual prior to undertaking any activities related to installation of your new Akrapovič exhaust system. In case you do not fully understand the manual or any of its parts, please contact your authorized dealer!

This product should be installed by someone with sufficient knowledge of exhaust systems and their installation, and appropriate hand or power tools. If you are not qualified for this work, please utilize a certified mechanic for installation. By installing Your Akrapovič exhaust system, you indicate that you have read the installation manual in its entirety and you agree with the terms stated herein.

It is your responsibility to follow all installation instruction guidelines supplied with the Akrapovič exhaust system and undertake all necessary safety precautions. Akrapovič d.d. assumes no responsibility for damages occurring from misuse, abuse, improper installation, improper operation, lack of responsible care, or all previously stated reasons resulting from incompatibility with other manufacturer's products and/or systems.

IMPORTANT INFORMATION

Exclusion of Certain Liability

1. The manufacturer, importer or dealer shall not be liable for any incidental damage including personal injury or any other damages caused by improper installation or operation of the Akrapovič exhaust system. When installing the Akrapovič exhaust system be careful that the exhaust system does not touch other parts sensitive to high temperature.
2. Akrapovič makes no representation or warranties with regard to damage caused by the improper installation, use and maintenance of the Akrapovič exhaust system. The warranty is limited to defects recognized by our technical department and due to normal use, and excludes items subject to normal wear (gaskets and damping wool). The guarantee is void in case of accident, modification, improper or competition use.
3. Do not attempt to install the Akrapovič exhaust system on a vehicle model for which it was not made or tested by Akrapovič.
4. When the exhaust system gets very hot during operation, be careful not to burn yourself on the exhaust system or parts which are in direct contact with it, even when the engine is not running. Also protect other people, especially children, from the injuries mentioned above.

1. In some cases Akrapovič exhaust system kits contain chemical products (ceramic anti-seizing grease; bolt sealant). Handle with care, do not inhale or swallow. Avoid excessive contact with skin, eyes or mucous membranes. Keep out of reach of children.
2. Technical specifications of Akrapovič exhaust systems and related products are subject to change without notice.
3. Before removing the original exhaust system from your vehicle, please compare the parts you received with the list of materials provided in the installation manual in order to assure that you have all the parts necessary for the installation of your new Akrapovič exhaust system.
4. Although this manual consists of instructions for installation in written form, as well as photographs and pictures representing individual steps of the installation, please note that the photographs and pictures are symbolic and are intended for representation of general overview only. The photographs and pictures contained herein should serve as a guideline only and actual installation of the exhaust system may not correspond with the photographs and pictures entirely.
5. The process of uninstalling the original exhaust system may vary depending on the existing exhaust system. Please follow the original exhaust system manufacturer's instructions for uninstalling the original exhaust system.

Trademarks

The Akrapovič Exhaust System Technology logo is a registered trademark of Akrapovič d.d.

Akrapovič website

Information about Akrapovič exhaust systems and related products is available on the Akrapovič website at:

<http://www.akrapovic.com/>

Copyright

No part of the Akrapovič exhaust system or its documentation may be reproduced or distributed in any form or by any means without the prior written authorization of the Akrapovič company.

© Akrapovič, d.d. All rights reserved.

Symbols

The following symbols are used throughout these installation instructions:



TOOLS REQUIRED



TIGHTENING TORQUE



INSTALLATION TIP



CAUTION OR WARNING



USE BOLT SEALANT; Apply 3 to 4 small drops of bolt sealant onto the cleaned and degreased threads before tightening the bolts. **WARNING! Avoid contact with skin, eyes and mucous membranes. Do not inhale fumes. Keep out of the reach of children.**



USE ANTI-SEIZE LEAD-FREE COPPER PASTE (black tube); Provides trouble-free and long-lasting protection against seizing, corrosion and rusting of bolts, threaded ends, nuts, joints, etc. Also protects against vibration, wear and impact. **WARNING! Avoid eye contact. Avoid excessive skin contact. Keep out of reach of children.**



USE ANTI-SEIZING GREASE (white tube); Prevents seizing, corrosion and excessive wear between the titanium components of your exhaust system. **WARNING! Avoid eye contact. Avoid excessive skin contact. Keep out of reach of children.**

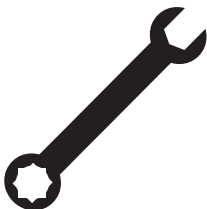

Jig saw or equivalent
T-handle 13mm wrench
T-handle swivelling 10mm wrench
Torx 20 wrench
Combination 13mm wrench
Combination 15mm wrench
Combination 22mm wrench
Flat screwdriver
Small crow bar



BEFORE INSTALLING, CHECK THE SCHEMATIC OF THE EXHAUST SYSTEM!



IF ANY ITEMS IN THE AKRAPOVIČ EXHAUST SYSTEM PACKAGE ARE MISSING, PLEASE CONTACT YOUR AUTHORIZED DEALER. KEEP THE SCHEMATIC FOR FUTURE REFERENCE.



THESE INSTALLATION INSTRUCTIONS MUST BE READ CAREFULLY IN ORDER TO ENSURE PROPER INSTALLATION AND OPERATION OF THE AKRAPOVIČ EXHAUST SYSTEM.



THE EXHAUST SYSTEM CAN BE EXTREMELY HOT. ALLOW THE EXHAUST AND ENGINE TO COOL DOWN BEFORE BEGINNING INSTALLATION.



WE ADVISE YOU TO LEAVE INSTALLATION TO A QUALIFIED SERVICEMAN. IMPROPER INSTALLATION MAY RESULT IN A SHORTER LIFETIME OF THE EXHAUST SYSTEM AND/OR DAMAGE TO THE VEHICLE.

REMOVAL OF ORIGINAL EXHAUST SYSTEM:

Put the vehicle onto a car lift.

! **WARNING:** make sure, that car lifting is safely and correctly done or you risk vehicle damage, injury or even death!

1. **For Slip-On and Evolution:** mark original muffler's inlet pipe **50mm** from the impressed dot , as shown in figures. Cut the pipe, using angle grinder, jig saw or equivalent (**Figure 1, 2**).

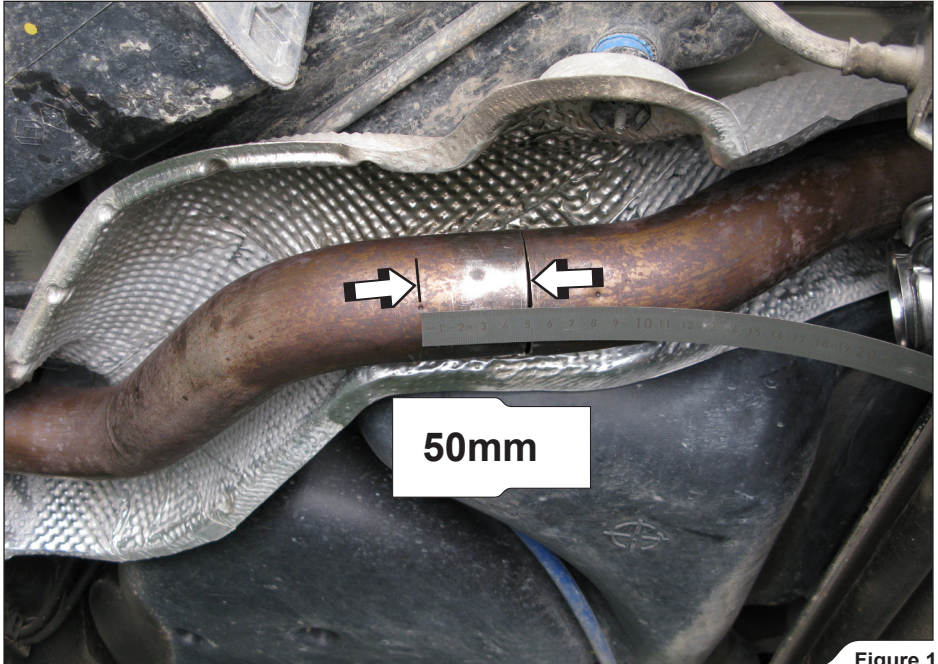

Figure 1

! WARNING: make sure, that you don't injure yourself or damage any part of the vehicle during cutting process! Use personal protection equipment!



Figure 2

2. **For Slip-On and Evolution:** unscrew the marked nuts and bolts and remove the diffuser off the vehicle (**Figure 3**).

! WARNING: make sure, that you support the diffuser during this process or you could injure yourself or damage the vehicle!

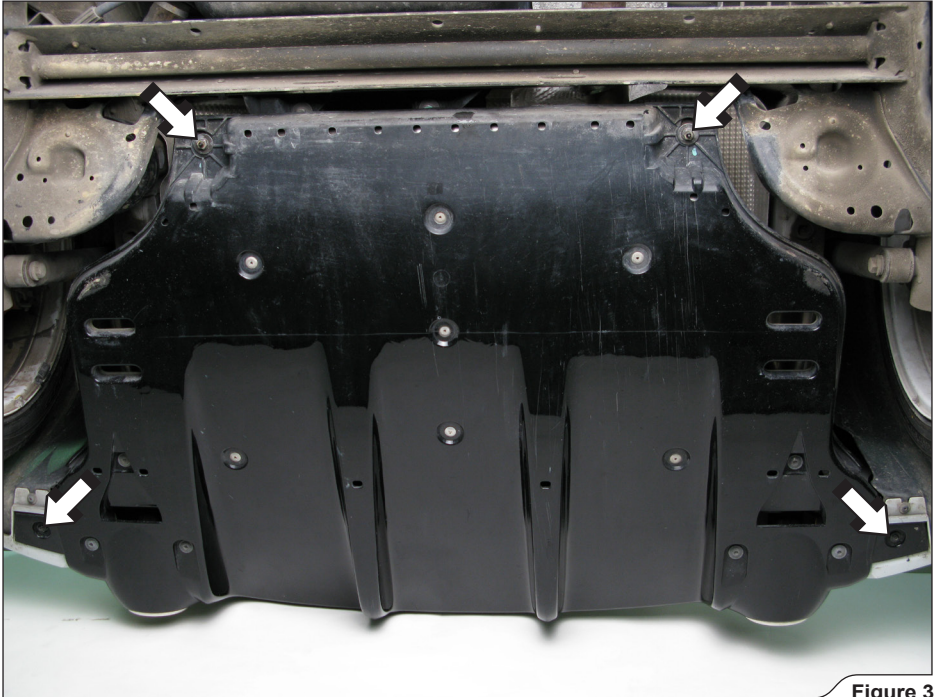

Figure 3

3. **For Slip-On and Evolution:** pull the rubber brackets off the muffler and remove the muffler off the vehicle (Figure 4).

! **WARNING:** make sure, that you support the original muffler during this process or you could injure yourself or damage the vehicle!

AK **INSTALLATION TIP:** for easier dismounting, lubricate the stock rubber brackets.



Figure 4

4. **For Slip-On and Evolution:** press the tail pipes' pins and remove both tail pipes off the diffuser (Figure 5, 6).

! **WARNING:** make sure, not to damage the tail pipes or diffuser during this process!



Figure 5



Figure 6

5. **For Evolution only:** unscrew the marked spherical clamp and lambda sensor (**Figure 7**).

! CAUTION: be careful not to damage the electrical lead or the lambda sensor during this process!



Figure 7

6. **For Evolution only:** unscrew the marked bracket bolt and remove the original middle pipe off the vehicle (**Figure 8**).

! **WARNING:** make sure, that you support the middle pipe during this process or you could injure yourself or damage the vehicle!



Figure 8

INSTALLATION OF THE AKRAPOVIČ EXHAUST SYSTEMS:

1. **For Slip-On and Evolution:** attach the Akrapović carbon fiber tail pipes to the diffuser, as shown (Figure 9, 10).

! WARNING: make sure, not to damage the tail pipes or diffuser during this process!



Figure 9

! CAUTION: make sure, that all pins hook to the diffuser correctly!



Figure 10

2. **For Evolution only:** hang the Akrapovič middle pipe onto the bracket, using original bolt. Tighten the bolt to the specified torque (**Figure 11**).

! **WARNING:** make sure, that you support the middle pipe during this process or you could injure yourself or damage the vehicle!

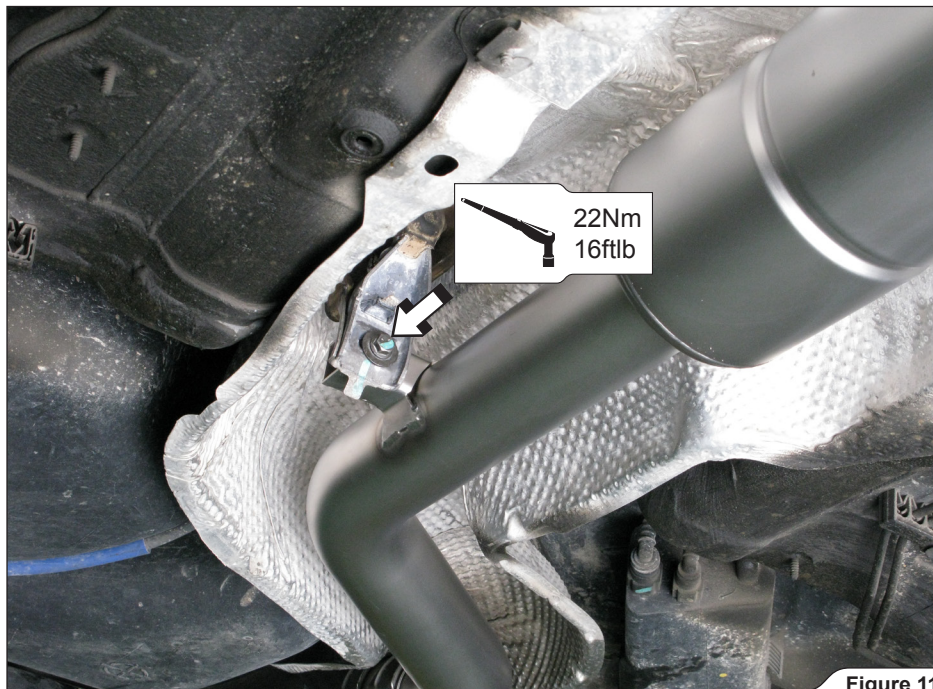

Figure 11

3. **For Evolution only:** install the lambda sensor and tighten the original spherical clamp to the specified torques (**Figure 12**).

! **CAUTION:** be careful not to damage the electrical lead or the lambda sensor!

! **WARNING:** use anti-seize copper paste on spherical clamp's bolt and lambda sensor's threads!

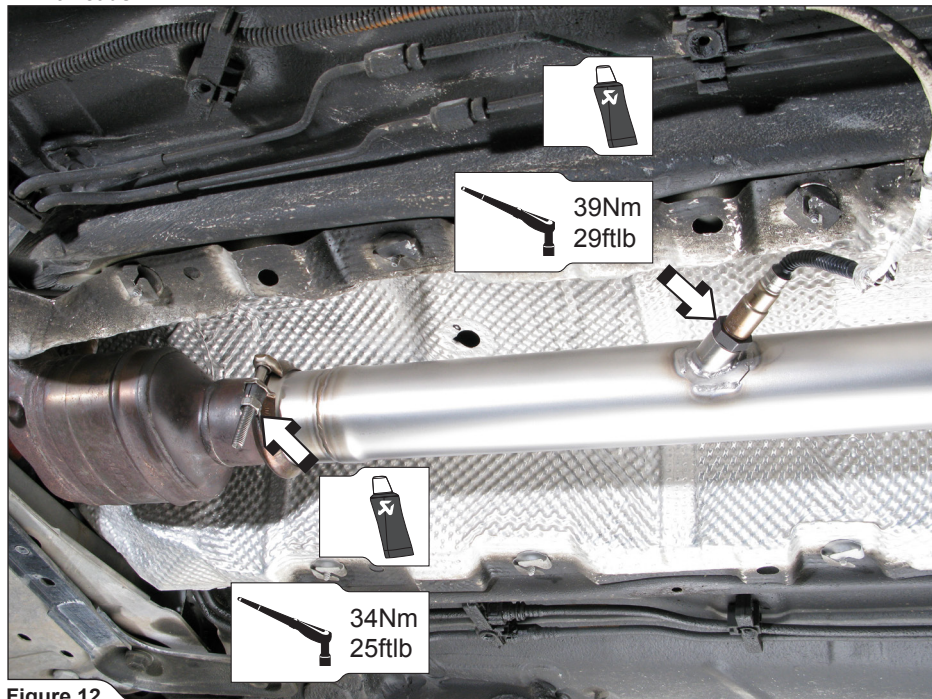

Figure 12

4. **For Slip-On and Evolution:** correctly assemble the muffler's inlet pipe and tighten the clamp to the specified torque (**Figure 13, 14**).

! WARNING: use anti-seize copper paste on clamp's bolt threads!



Figure 13

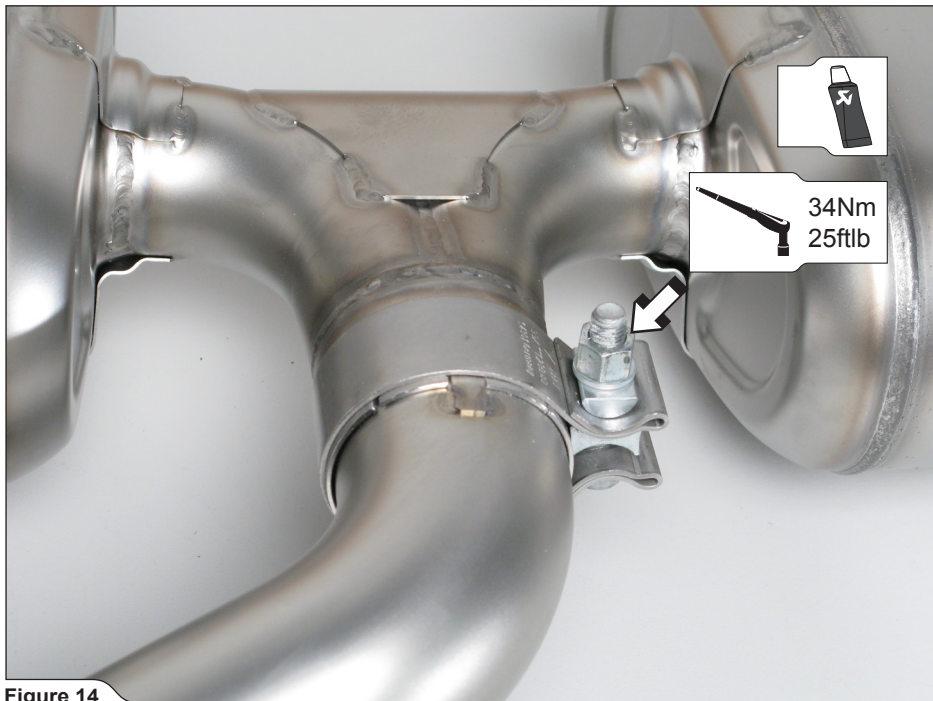

Figure 14

5. **For Evolution only:** slide the double clamp onto the muffler inlet pipe (**Figure 15**).

! **WARNING:** use anti-seize copper paste on all nut threads!

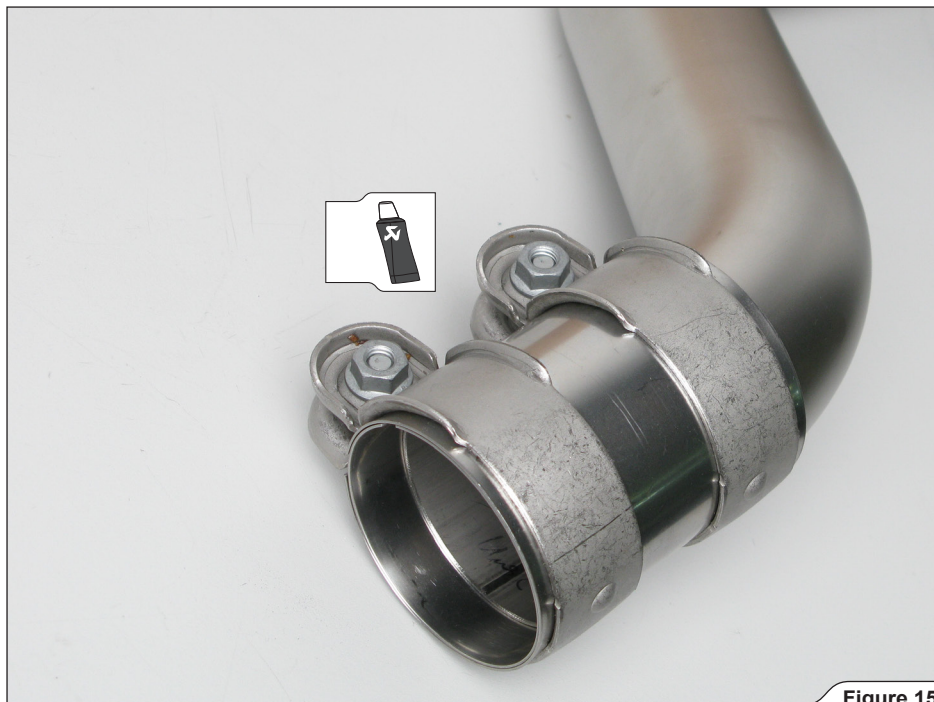

Figure 15

6. **For Slip-On only:** correctly assemble the clamps and adapter pipe onto the muffler inlet pipe (Figure 16).

! **WARNING:** use anti-seize copper paste on all clamps' nut threads!

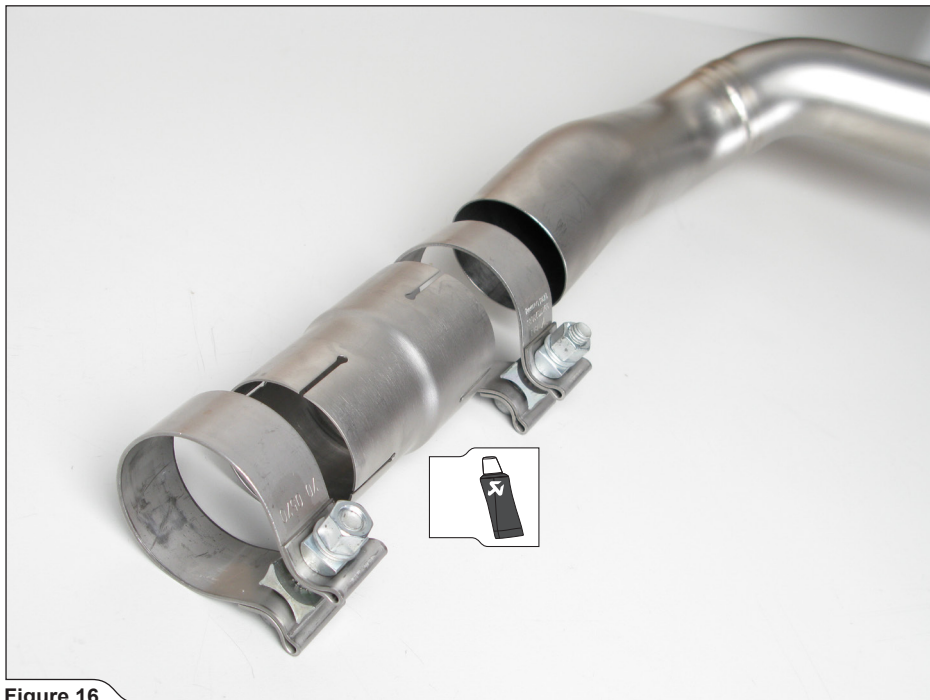

Figure 16

7. **For Evolution only:** put the muffler onto the vehicle and slide the double clamp over the middle pipe-muffler's inlet pipe joint (**Figure 17**).

! **WARNING:** do not fully tighten the double clamp yet!



Figure 17

8. **For Slip-On only:** put the muffler onto the vehicle and slide the adapter onto the original middle pipe (**Figure 18**).

! WARNING: do not fully tighten the adapter's clamps yet!



Figure 18

9. **For Slip-On and Evolution:** hang the muffler on the stock rubber brackets. Center the muffler in respect to the vehicle. If necessary, loosen the marked bolts, center the muffler, than retighten the bolts to the specified torque - 22Nm/16ftlb (**Figure 19**).

W INSTALLATION TIP: for easier mounting, lubricate the stock rubber brackets.

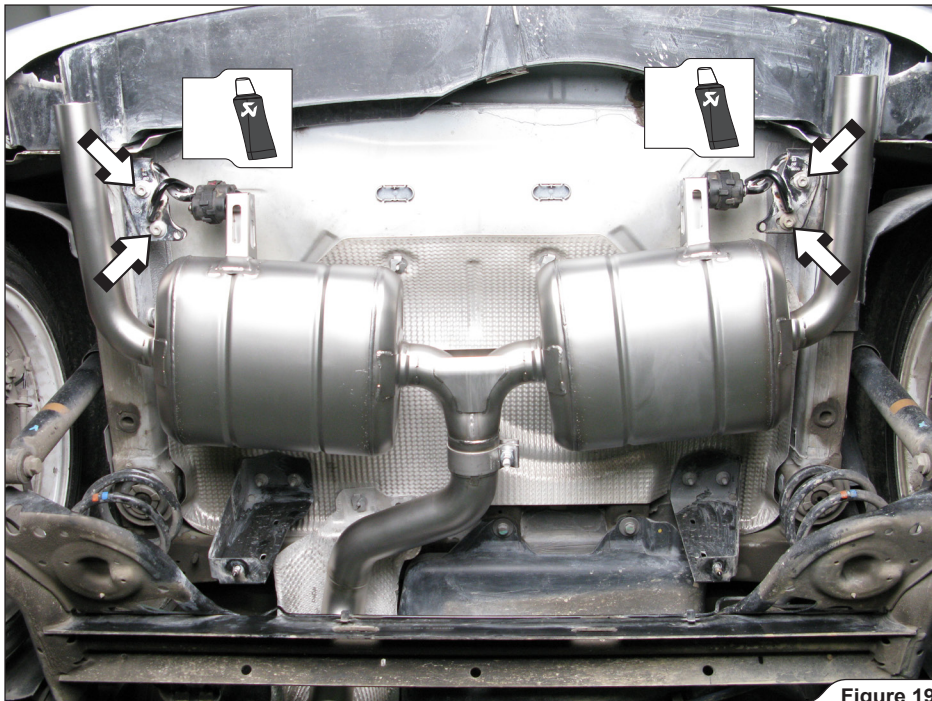

Figure 19

10. **For Slip-On and Evolution:** center the muffler-height wise. The muffler's outlets on both sides of the vehicle must be equally distanced from the chassis (**Figure 20**).



Figure 20

11. **For Evolution only:** push the middle and muffler inlet pipe together, center the double clamp over the joint and tighten it to the specified torque (**Figure 21**).

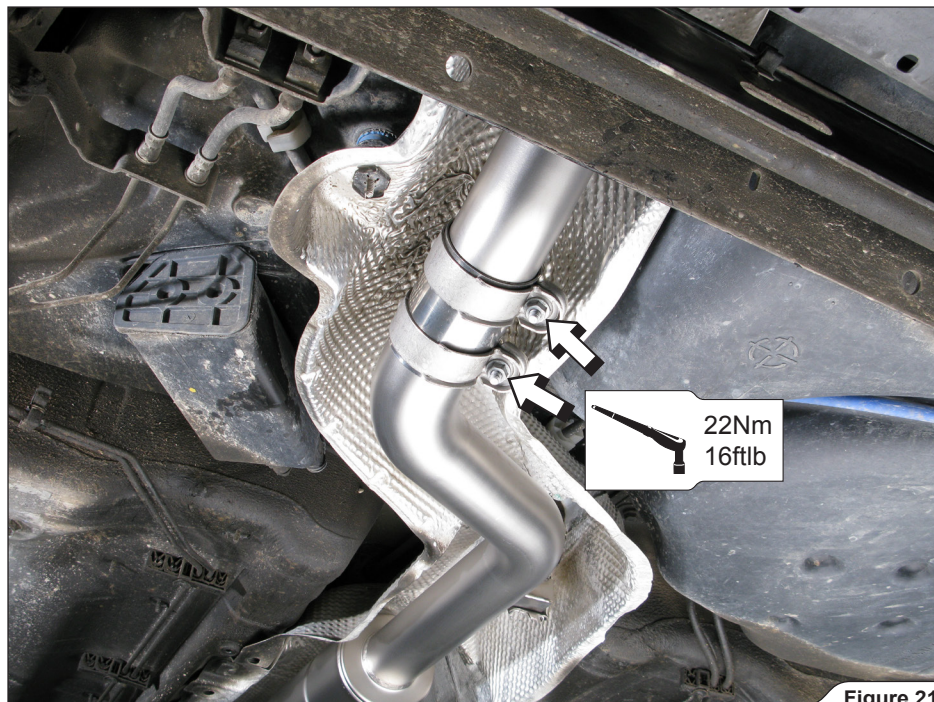

Figure 21

12. **For Slip-On only:** push the middle and muffler inlet pipe together and tighten the clamps to the specified torque (**Figure 22**).

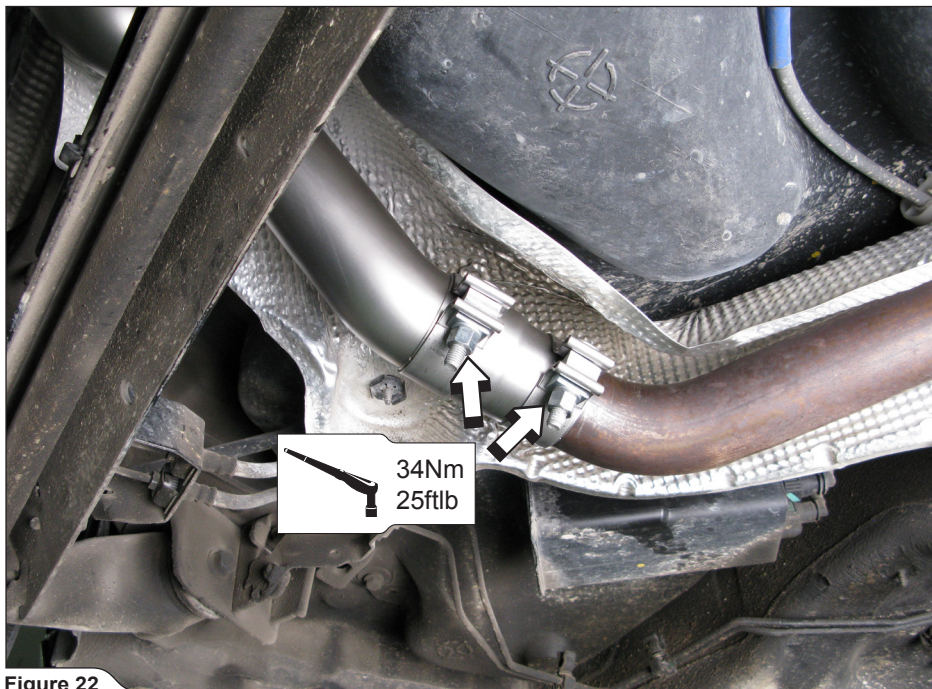

Figure 22

13. **For Slip-On and Evolution:** reinstall the diffuser (Figure 23).



Figure 23

Final installation:

- ! **WARNING:** check vehicle manufacturer manual for tightening torques (for dismounted stock parts)!
- ! **WARNING:** make sure all the nuts and bolts are sufficiently tightened. In case the exhaust system touches the cowl or other parts, repeat the adjustment of the exhaust system or contact your authorized dealer.

MAINTENANCE OF THE AKRAPOVIČ EXHAUST SYSTEM:

1. Clean the titanium exhaust components with a multi-purpose spray lubricant (WD-40 or equivalent), carbon fiber exhaust components with soft and dry cloth and stainless steel components with soft cloth sprayed with contact cleaner, then wipe with soft and dry cloth. A change in the color of the exhaust system is normal due to high temperatures.
2. Periodically make sure all the bolts and springs are sufficiently tight.

- ! **WARNING:** clean all exhaust components before the first start of the engine or the stains will burn onto the surfaces!
- ! **IT IS NORMAL IF WHITE SMOKE COMES OUT OF THE MUFFLER ON FIRST OPERATION.**
- ! **DO NOT STAND BEHIND THE MUFFLER ON FIRST OPERATION.**
- ! **DO NOT USE AUTOMOTIVE WHEEL CLEANERS OR ANY CLEANING PRODUCTS WHICH CONTAIN ACIDIC ADDITIVES TO CLEAN AKRAPOVIČ EXHAUST SYSTEMS.**

Clio RS Slip-on exhaust system/Stainless steel/Street legal
Product code: MTP-RECL3RSH

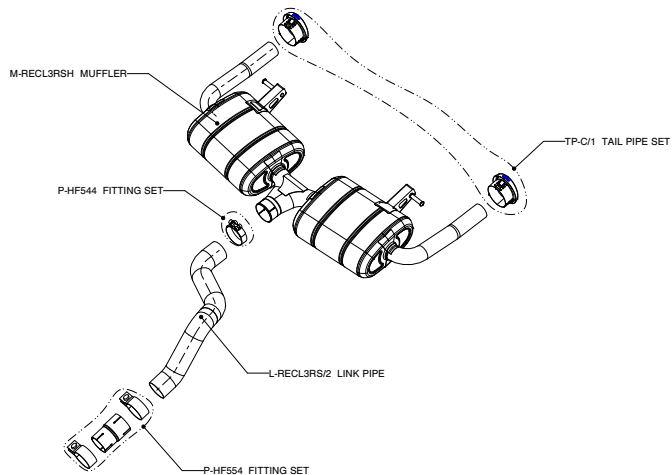

Clio RS Evolution exhaust system/Stainless steel
Product code: S-RECL3RS

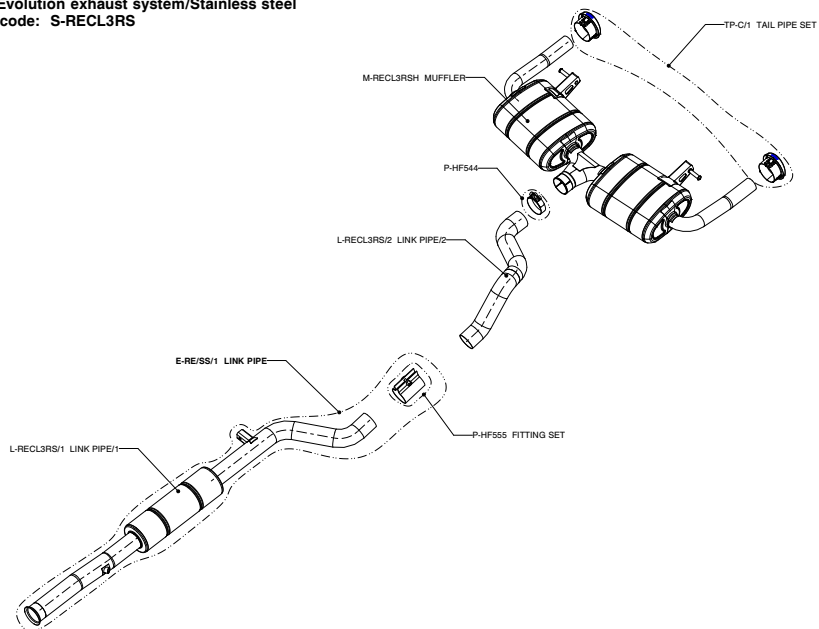

www.akrapovic.com



502907